

SETTING THE NUMBER OF CONTESTING CANDIDATES

12. Open the Compartment at the bottom of the Control Units as explained in para 24 of Chapter 1, and proceed as follows for setting the No. of contesting Candidates.
 - a) Inter connect 4 BUs in series. Connect the first Ballot Unit to the Control Unit by plugging the male connector of the interconnecting Cable in to the female connector in bottom compartment of CU.

Interconnection figures and guide lines are as follows:

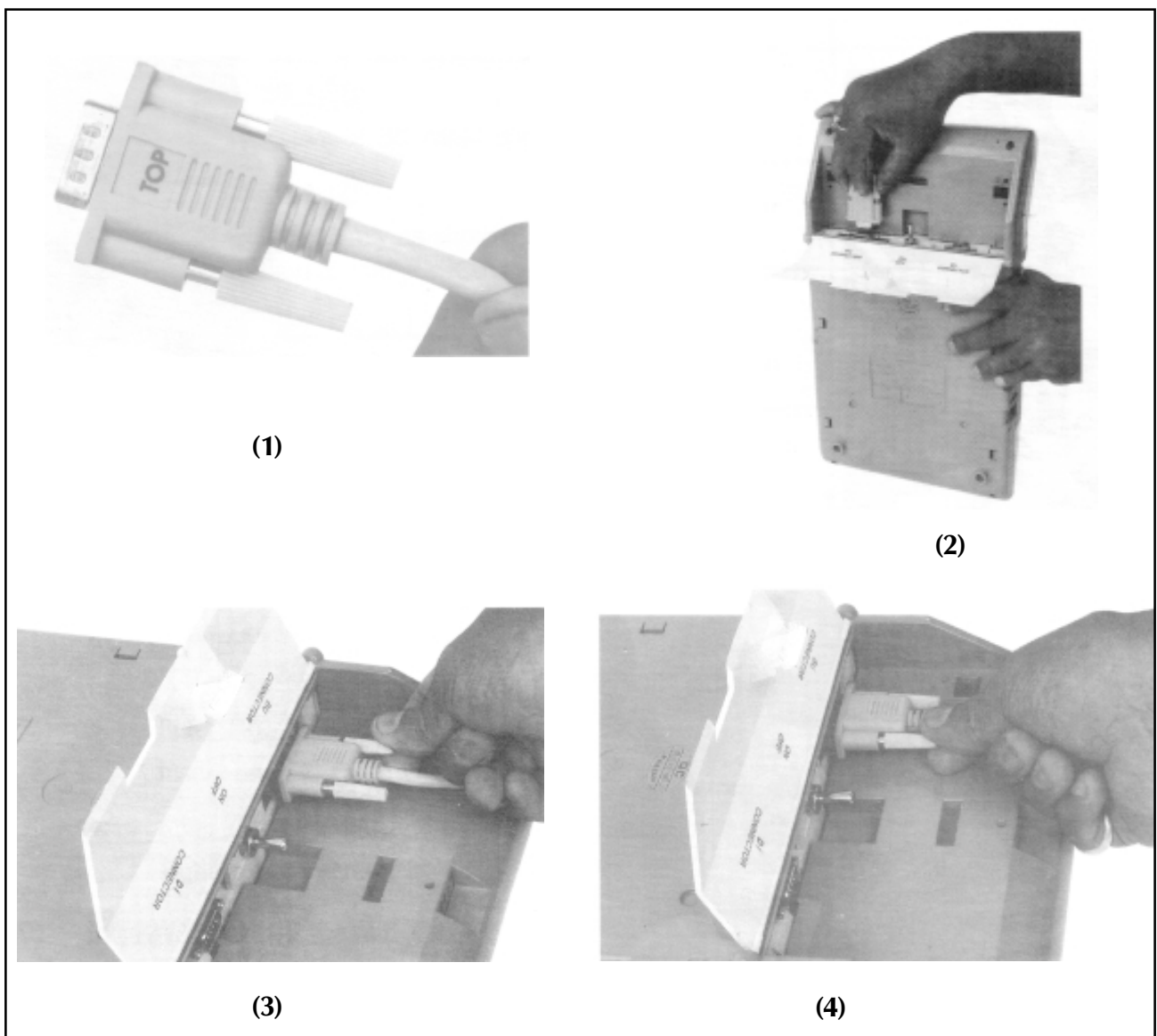

Fig. 20 A Proper insertion of BU cable connector into CU Connector.

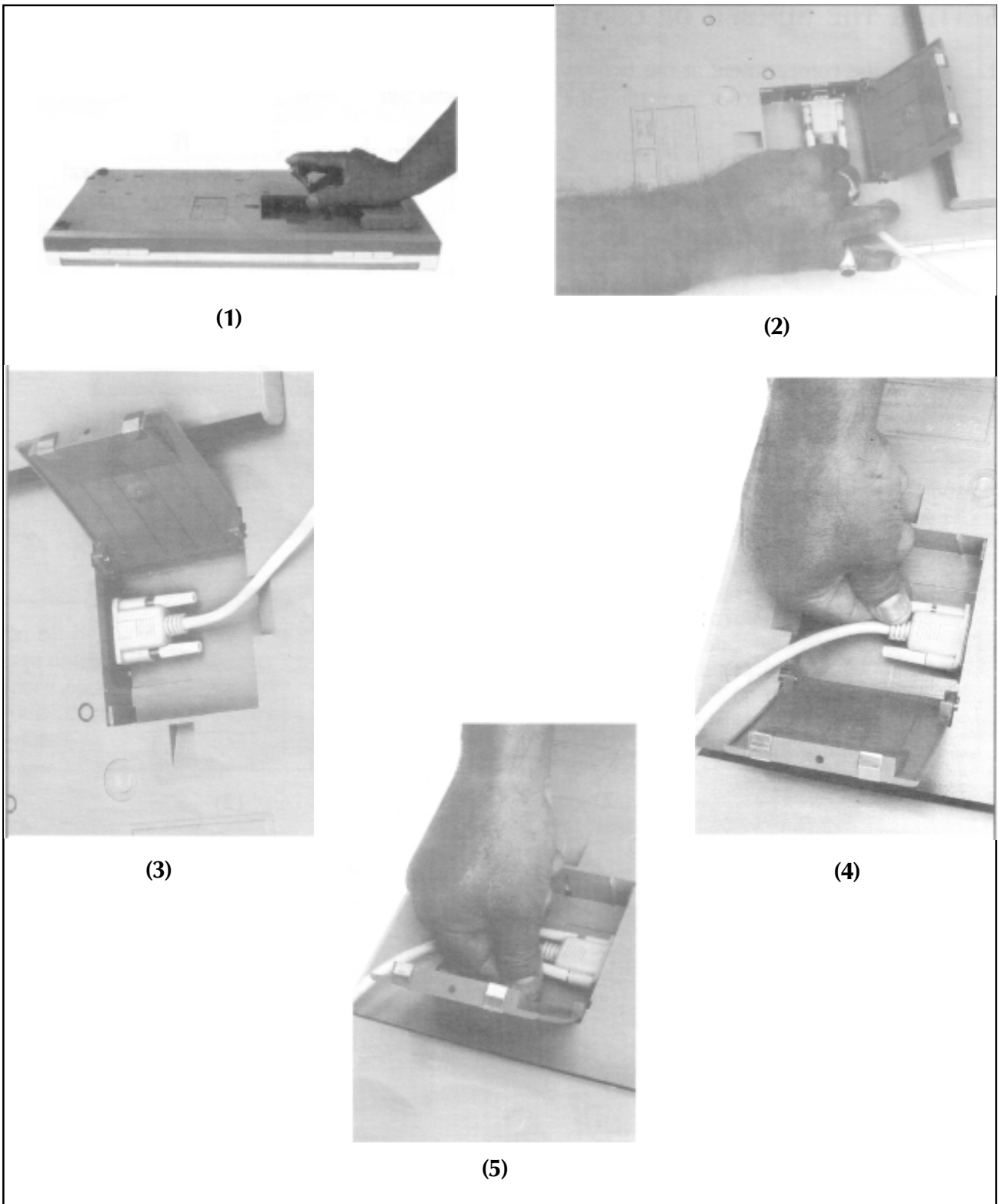

Fig. 20 B Proper insertion of one BU cable connector to other BU connector.

INTER CONNECTION GUIDE LINES

Proper interconnection is very important. If interconnection is not done properly it will lead to Link Error.

As the male connector and female connector are multipin connectors, it will need some practice to interconnect them properly. The male connector goes into the female connector in one way only which can be found out easily by looking at the orientation of the pins and "Top" printed on the connector hood. After the male and female connectors are connected properly they are to be locked by tightening of two side screws.

INTER CONNECTION AND REMOVAL ARE EXPLAINED AS FOLLOWS:

A) INTERCONNECTION OF BU CABLE CONNECTOR TO CU CONNECTOR

1. Refer Fig. 20 A (1)
Pull back screws of BU cable connector
2. Refer Fig. 20 A (2)
Hold the CU vertically as shown. Hold the BU cable connector with "TOP" side facing the unit and insert it into the CU connector.
3. Refer Fig 20 A (3) and (4)
Tighten the screws in clockwise direction.

B) INTERCONNECTION OF ONE BU CABLE CONNECTOR TO THE NEXT BU BOTTOM CONNECTOR

1. Refer Fig. 20 B (1)
Keep the BU in horizontal and upside down position. Open the door of connector compartment.
2. Refer Fig. 20 B (2)
Align the BU cable connector properly with "TOP" side facing the unit.
3. Refer Fig. 20 B (3)
Insert one BU cable connector into the next BU bottom side connector
4. Refer Fig. 20 B (4) and (5)
Tighten the screws in clockwise direction.

C) REMOVAL OF BU CABLE CONNECTOR FROM CU CONNECTOR

1. Open the CU bottom compartment door.
2. Switch OFF CU.
3. Unscrew both the screws of the BU cable connector in anticlockwise direction.
4. Pull out the BU cable connector.
5. Close the CU bottom compartment door.

D) REMOVAL OF BU CABLE CONNECTOR FROM OTHER BU CONNECTOR

1. Open the BU bottom door of connector compartment.
2. Unscrew both the screws of the BU cable connector in anticlockwise direction.
3. Pull out the BU cable connector.
4. Close the BU connector compartment door.

- b) After plugging the connectors properly, push the 'Power' switch to 'ON' position. It will give beep sound and the "ON" lamp (Fig.6) on the Display Section of the Control Unit will glow GREEN.
- c) After the 'ON' lamp glows GREEN, press the 'Cand. Set' Button (Fig. 8) in the Candidate Set Section. There upon the 2 digit Display Panel in the Display Section will now flash the letters "np" and the 4 digit Display Panel will flash

Note: If, however, the Digit display panel shows the ward 'no', it signifies that data relating to some previous operation is in the machine. In such situation, the previous data has to be cleared for setting the number of contesting candidates. For this purpose, press the 'Close' button and wait for the completion of the displays (including the display 'End') on the display panels. Thereafter, press the 'Result I' button. Wait till display 'End' appears again. Now press the 'Clear' button and again wait till display 'End' appears. Thereafter press the 'Cand Set' Button and now the display flashes --

- d) Assume that there are eight posts. When the letters "np - -" start flashing on the Display Panels on the Control Units, press the Candidate's button number eight in Ballot Unit. On that button being pressed, The Display Panels will stop flashing the letters "np - -" and starts flashing "F1 - -"

Further setting can best understood by the following EXAMPLE:

Let the assumed eight posts are as follows:

Post No.	Post name	No of Contesting Candidates	No. of Choice for voter
P1	President	4	1
P2	Vice President	9	2
P3	General Secretary	9	1
P4	Joint Secretary	12	3
P5	Treasurer	6	1
P7	Welfare Secretary	3	1
P8	Cultural Secretary	6	2

Then the settings can be carried out as follows:

Note	Display Flashed	BU No.	Button to be pressed	Meaning
On BU No. 1 Button No. 1 masked on Ballot paper space opposite button no. 1 "PRESIDENT" is printed.				
	F1 - -	1	2	The name of 1st candidate for post no. 1 is opposite button no. 2 on Ballot Unit 1
	L1 - -	1	5	The name of last candidate for post no. 1 is opposite button no. 5 on Ballot Unit 1
	P1 04 -	1	2	for post no. 1,(President) there are 4 contestants out of whom the voter has a choice to elect 1
On BU No. 1 Button no. 6 is masked. On ballot paper space opposite button no. 6 "VICE PRESIDENT" is printed				
	F2 - -	1	7	The name of the last candidate for post No is opposite button no 7 on BU 1.
	L2	1	15	The name last candidate for post no.2 is opposite button no. 15. on BU 1.
	P2 09 - -	1	8	For post no. 2(vice President) there are 9 contestants out of whom the voter has a choice to elect 2.
On BU No.1 on the Ballot paper space opposite button No. 16 is kept blank and button no. 16 is masked.				
On BU No. 2 button No.1 is masked. On Ballot paper space opposite button no.1 "GENERAL SECRETARY" is printed.				

Note	Display Flashed	BU No.	Button to be pressed	Meaning
	F3 --	2	2	The name of the first candidate for post no. 3 is opposite button no. 2 on BU no. 2.
	L3 --	2	10	The name of the last candidate for post no. 3 is opposite button no.10 on BU no. 2.
On BU no. 2 Button no. 11 is masked. On ballot paper space opposite button no. 11"JOINT SECRETARY" is printed	P3 09 --	2	2	For post no. 3 (GeneralSecretary) There are 9 contestants out of whom the vote has a choice to elect one.
	F4 --	2	12	The name of the first candidate for post no. 4 is opposite button no. 12 on BU no. 2.
	L4 --	3	8	The name of the ast candidate for post no.4 is opposite button no. BU no. 3
	P4 12 --	2	14	For post no.(Joint Secretary)There are 12 contestants out of the voter has a choice to elect three.
On BU NO. 3 Button no. 9 is masked. On ballot paper space opposite button no. 9 "TREASURER" Is printed.				
	F5 --	3	10	The name of the candidate for post no.5 is opposite button no. 10 on BU no.3
	L5 --	3	15	The name of the first candidate for post no. 5 is opposite button no. BU no. 3.
	P5 06 --	3	10	For post no. 5(Treasurer) There are 6 contestants out of whom the voter has a choice to elect One.

Note	Display Flashed	BU No.	Button to be pressed	Meaning
On BU No. 3 the ballot paper space opposite button no. 16 is kept blank and button no. 16 is masked.				
On BU No. Button 1 is masked. On ballot paper space opposite button no. 1 "SPORTS SECRETARY" is printed.				
	F6 --	4	2	The name of the first candidate for post no.6 is opposite button no. 2 on BU no. 4
	L6	4	4	The name of the last candidate for post no. 6 is opposite button no.4 on BU no. 4
	P6 03 --	4	2	For post no. 6 (SPORTS SECRETARY) There are 3 contestants out of whom the voter has choice to elect One.
On BU No. 4 Button no. 5 is masked. On ballot paper space opposite button no.5 "WELFARE SECRETARY" is printed				
	F7 --	4	6	The name of the first candidate for post no. 7 is opposite button no. 6 no. BU no. 4
	L7	4	8	The name of the last candidate for post no. 7 is opposite button no. 8 on BU no. 4.
	P7 03 --	4	6	For post no. 7 (WELFARE SECRETARY) There are 3 contestants out of whom the voter has a choice to elect One.

Note	Display Flashed	BU No.	Button to be pressed	Meaning
On BU No. 4 Button no. 9 is masked. On ballot paper space opposite button no. 9 "CULTURAL SECRETARY" is printed				
	F8 - -	4	10	The name of the first candidate for post no. 8 is opposite button no. 10 on BU no.4
	L8 - -	4	15	The name of the last candidate for post no. 8 is opposite button no.15 on BU no.4
	P8 06 --	4	11	For post no. (CULTURAL SECRETARY) There are 6 contestants out of whom the voter has choice to elect two.
OnBU NO. button no. 16 is kept open. On the ballot paper space opposite button no. 16"UNDER VOTE/NO VOTE"is printed				if the Voter does not wish to Vote/Wishes to Vote partially he has to pres the 16 button on BU NO.4 (in red colour with "END" marking) to record his voting.